

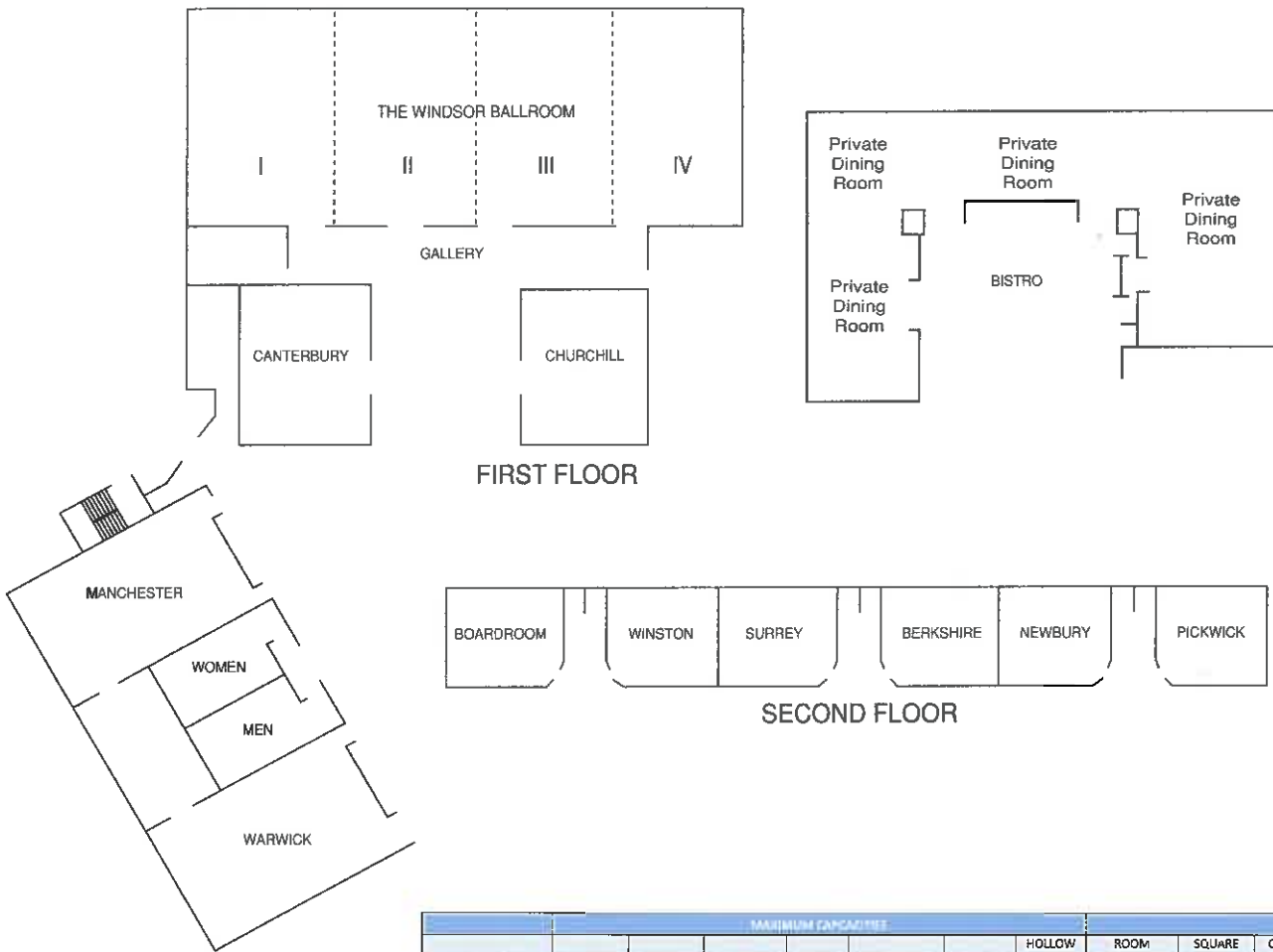

WYNDHAM

Dallas Suites - Park Central

Banquets and Meetings Rooms



ROOM	MAXIMUM CAPACITIES							ROOM DIMENSIONS	SQUARE FOOTAGE	CEILING HEIGHT
	BANQUET	RECEPTION	CLASSROOM	THEATRE	CONFERENCE	U-SHAPE	HOLLOW SQUARE			
WINDSOR BALLROOM	280	400	240	480				40' X 102'	4000	14'
I	70	100	60	120	40	30	35	40' X 25'	1000	14'
II	70	100	60	120	40	30	35	40' X 25'	1000	14'
III	70	100	60	120	40	30	35	40' X 25'	1000	14'
IV	70	100	60	120	40	30	35	40' X 25'	1000	14'
GALLERY									1530	
MANCHESTER	60	70	50	110	30	25	30	40' X 23'	920	12'
WARWICK	60	70	50	110	30	25	30	40' X 25'	1000	12'
CANTERBURY	50	60	36	70	20	20	25	40' X 25'	667	12'
CHURCHILL	50	60	36	70	20	20	25	40' X 25'	667	12'
WINSTON	30	40	18	40	15	12	15	18' X 21'	378	8'
SURREY	30	40	18	40	15	12	15	18' X 21'	378	8'
BERKSHIRE	30	40	18	40	15	12	15	18' X 21'	378	8'
NEWBURY	30	40	18	40	15	12	15	18' X 21'	378	8'
PICKWICK	30	40	18	40	15	12	15	18' X 21'	378	8'
BOARDROOM	8 person at conference table				8			12' X 18'	216	
BISTRO	80 with buffet								1500	
LOWER ATRIUM	80 maximum									
UPPER ATRIUM	40 maximum									
LOBBY BAR	40 maximum									
OXFORD SUITES	8 persons									

All Wyndham hotels are either franchised by the company or managed by Wyndham Hotel Management, Inc., one of its affiliates or through a joint-venture partner. © Wyndham Hotels and Resorts, LLC. All rights reserved