



WYNDHAM GRAND[®]

Clearwater Beach

DESCRIPTION

The Wyndham Grand Clearwater Beach Resort offers 343 luxuriously appointed guest rooms, spectacular vistas, waterfront bar and restaurant, including award-winning, sustainable, culinary creations from the Wyndham Grand's signature restaurant. Over 22,000 square feet of flexible meeting space, including the area's largest ballroom, will transform Clearwater Beach into a world-class event destination. Your experiences are limitless as you overlook the crystal gulf waters and experience dramatic sunsets painted on an infinite horizon.

LOCATION

As a top year-round destination, Clearwater offers a seemingly endless supply of entertainment, natural beauty, and outdoor activities both on land and at sea. Caressed by tranquil Gulf breezes, its beaches offer miles of sugar-white sand, crystal clear waters and are consistently ranked among America's most beautiful! No one can afford to miss this ultimate destination, ideally situated on Florida's stunning West Coast and offering something for every visitor and every budget.

- Tampa International Airport: 30 Minutes
- St. Pete-Clearwater International: 23 Minutes
- Orlando International Airport: 110 Minutes

GUEST ROOMS

King Bedded Rooms:	170
Double Queen Bedded Rooms:	137
King Bunk Family Rooms:	24
Parlor Suites:	6
Hospitality Suites:	4
Presidential Suites:	2
TOTAL:	343



MEETING SPACE

Wyndham Grand Clearwater Beach Resort offers over 22,000 square feet of flexible meeting and function space. The Grand Dunes Ballroom is located on the main floor with tasteful décor and pre-function space to host over 600 guests. If you're looking for the perfect backdrop, the Pelican Room allows your guests to enjoy the spectacular Gulf of Mexico views.

Meeting and function space:

<u>Room Name</u>	<u>Square Feet</u>
Dunes Ballroom	10,632 (Divides into five sections)
Sandpiper Room	1559 (Divides in to two sections)
Pelican Room	1403
Heron Room	1043
Egret Room	786
Ibis Room	784
Osprey Boardroom	394

Wireless internet access is available in guest rooms and throughout.



MEETING SPACE CAPACITY CHART

	Square Feet	Dimensions	Banquet Rounds of 10	Reception	Classroom	Theatre	Conference	Hollow Square	U-Shape
Dunes Ballroom	10632	144' x 74'	880	1060	440	1180	530	n/a	n/a
Dunes I	1739	48' x 37'	140	172	70	190	84	40	50
Dunes II	1785	48' x 38'	150	180	75	200	90	40	50
Dunes III	3584	48' x 74'	300	360	150	400	180	n/a	105
Dunes IV	1739	48' x 37'	140	175	70	190	84	40	50
Dunes V	1785	48' x 38'	150	180	75	200	90	40	50
Dunes Foyer	1461		n/a	150	n/a	n/a	n/a	n/a	n/a
Sandpiper	1559	54' x 29'	120	150	60	170	72	38	40
Sandpiper I	772	27' x 29'	60	75	30	85	36	20	22
Sandpiper II	787	27' x 29'	60	80	35	90	36	20	22
Pelican	1403	60' x 23'	110	140	55	155	66	34	40
Heron	1043	28' x 37'	80	100	40	115	60	25	30
Egret	786	27' x 29'	60	80	35	90	36	20	22
Ibis	784	28' x 28'	60	80	35	90	36	20	22
Osprey Boardroom	394	14' x 29'	n/a	n/a	n/a	n/a	10	n/a	n/a

* Our meeting room capacities have been calculated using the Meeting Professional International Comfort Calculator

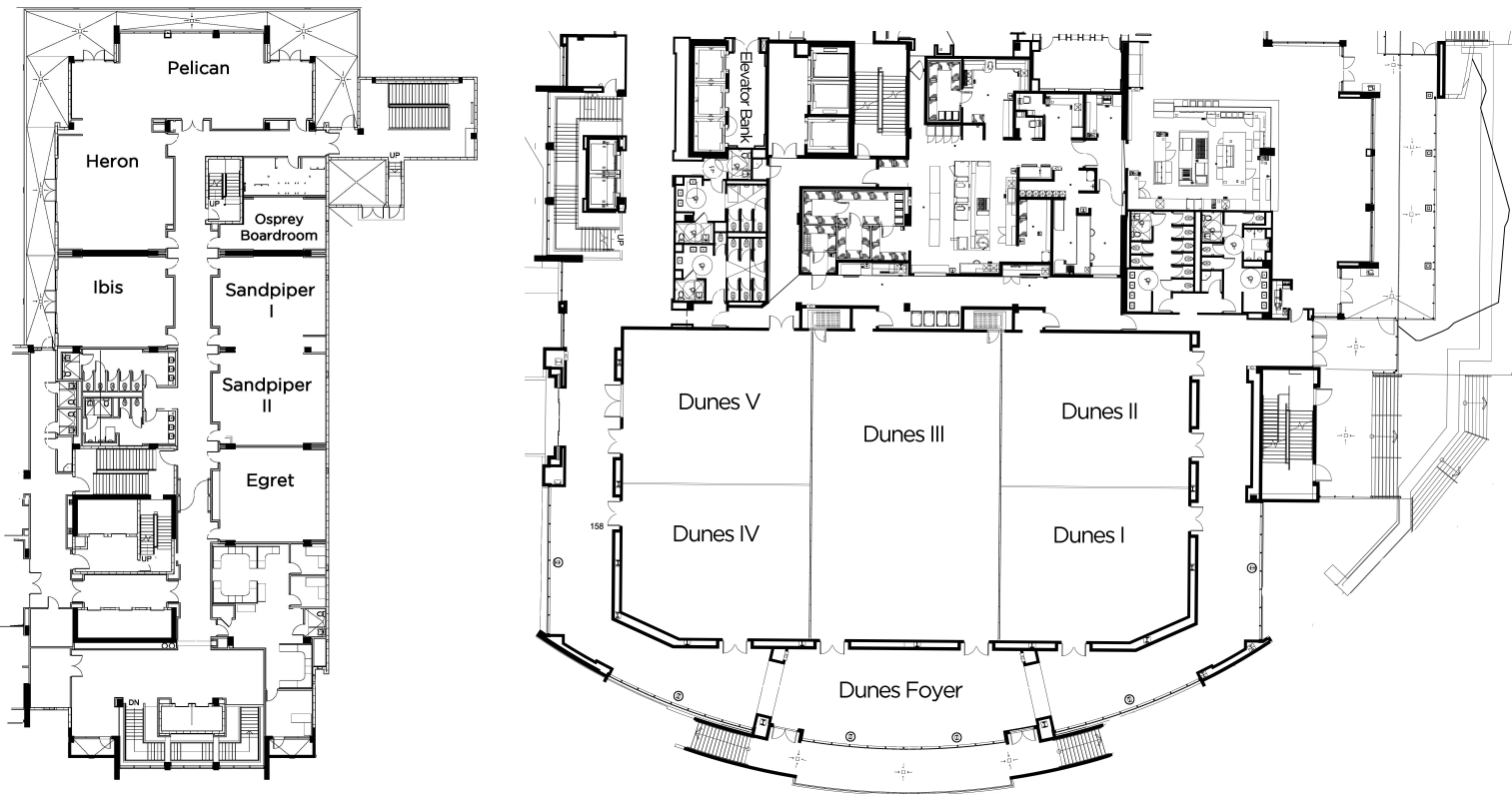

100 Coronado Drive, Clearwater, Florida 33767 | www.wyndhamgrandclearwater.com

©2013 Wyndham Hotels and Resorts, LLC. All rights reserved. All Wyndham® hotels are either franchised by the company or managed by Wyndham Hotel Management, Inc. or one of its affiliates.